

Barn A - Front View

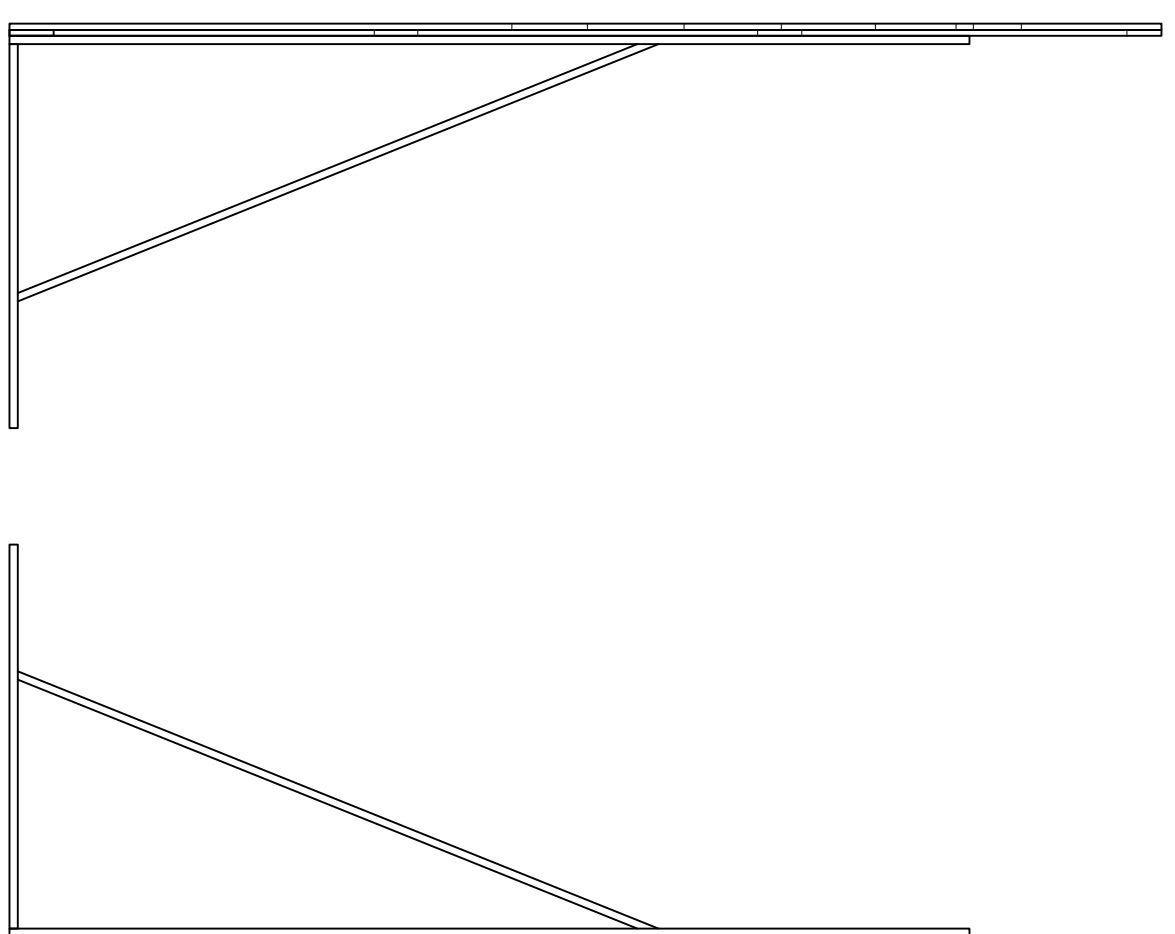

Barn A - Side View

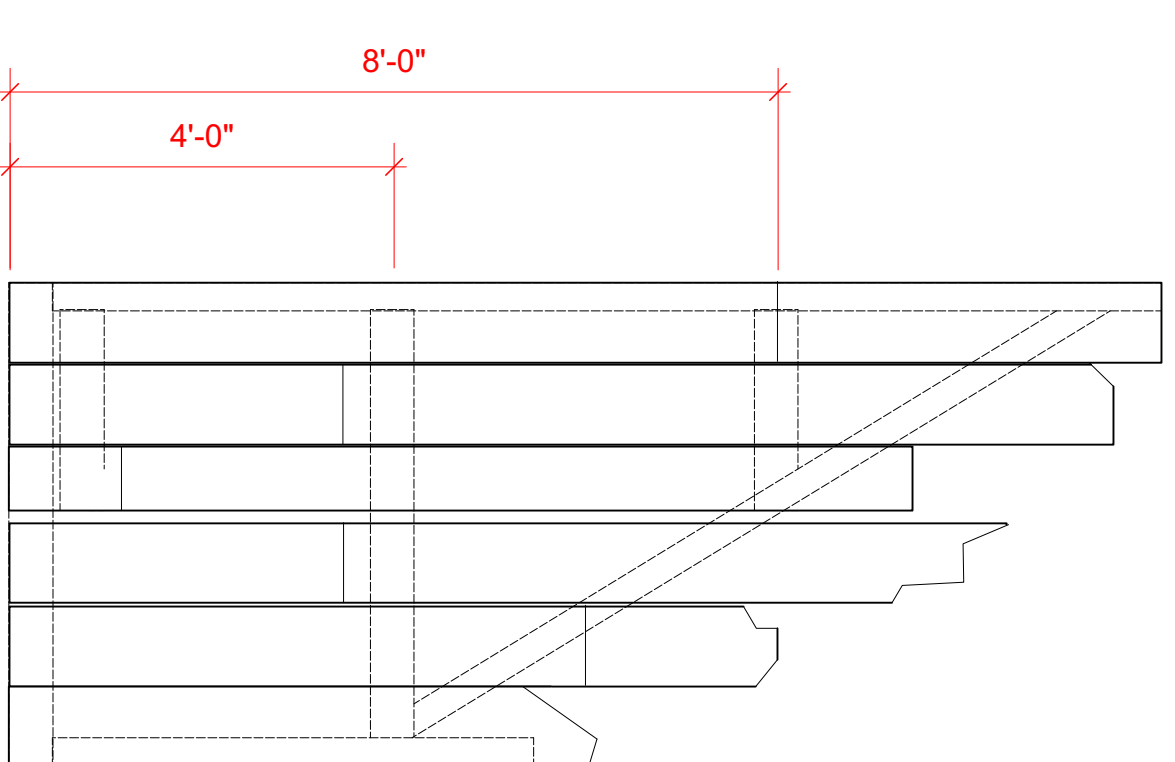

Barn C - Front View



Barn C - Side View

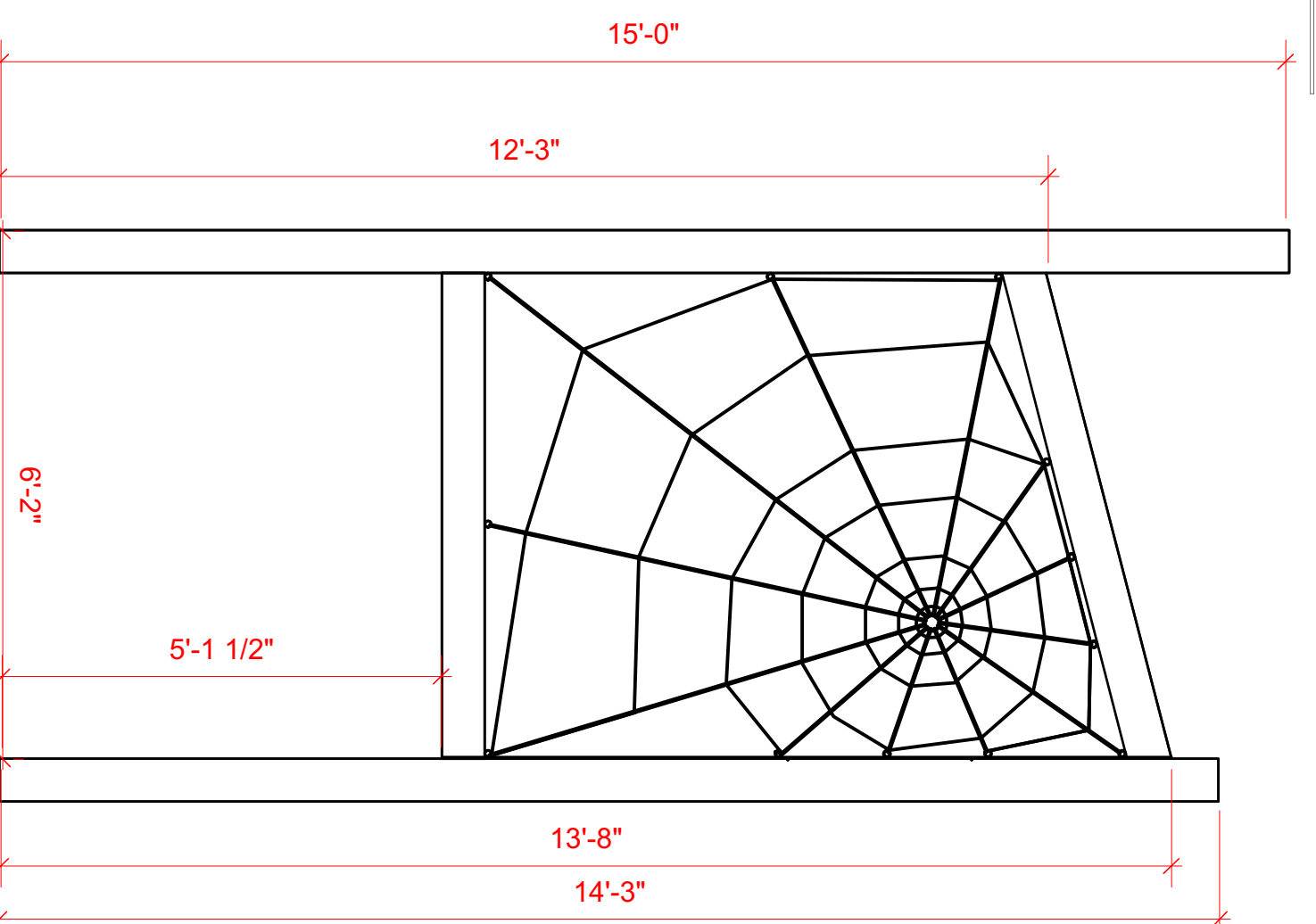

Web - Front View

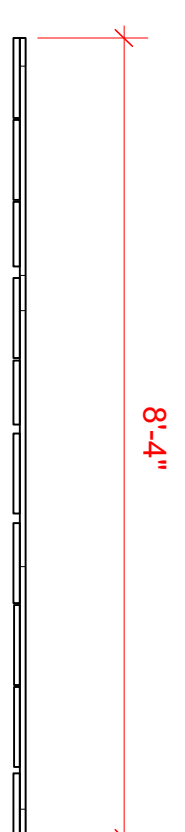

Barn A - Top View

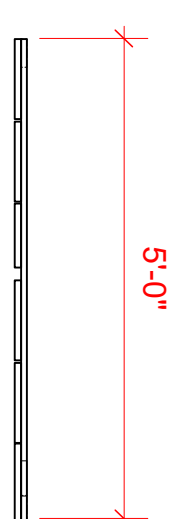

Barn C - Top View

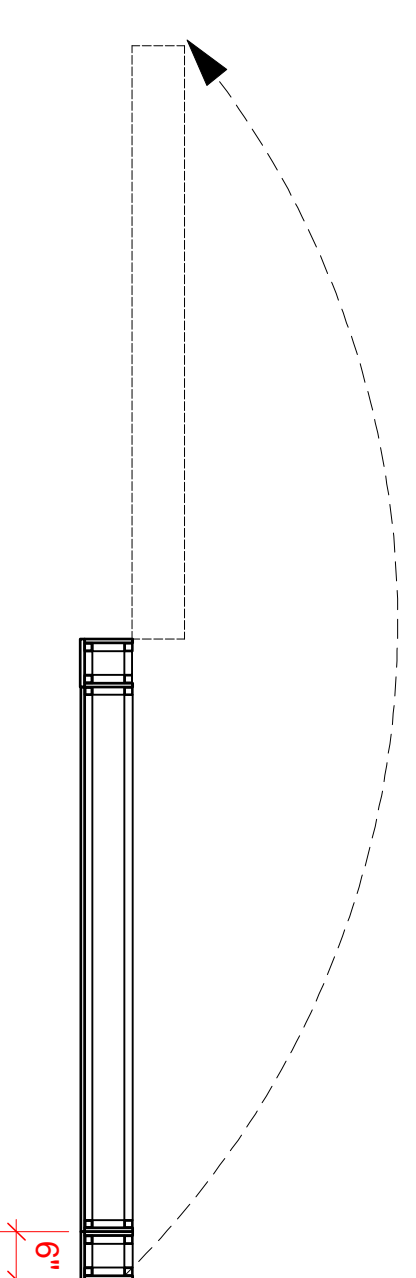

Web - Top View

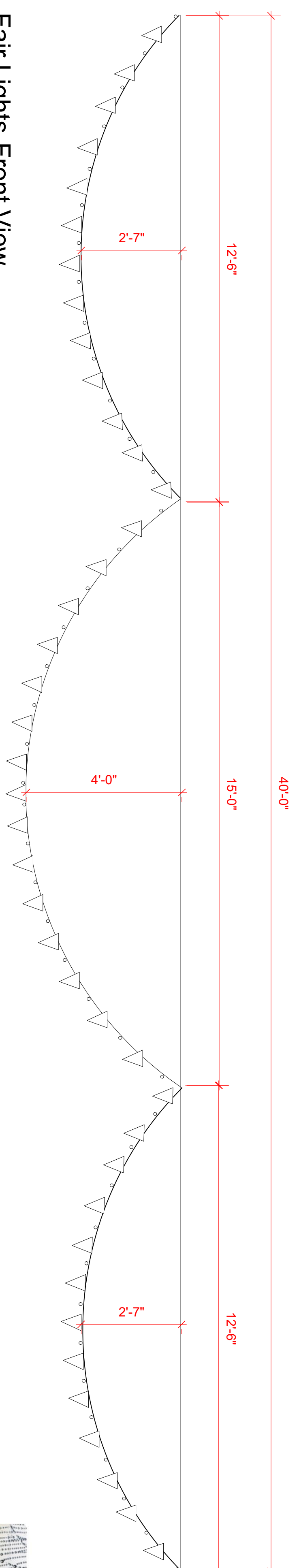

Fair Lights - Front View

BARN A and C B NOTES:

- Barn planks are drawn as 3/4" Plywood strips. Strips are both 10" and 8" wide
- Actual materials for planks are at TD's discretion
- Slats have small gaps between them that vary in width. TD can choose actual width as long as total length equals 8'-4"(A) and 5'-0" (B), and that they are placed at random.
- Planks vary in heights with seams sitting at 2'-6", 4'-0", 5'-2" and 8'-0". These seams should NOT be spackled or covered so seams shows through.
- Planks also have holes and distressed sections missing.
- Planks are shown as being backed with 1x6 but could be done with Plywood cut to 6" strips

FAIR LIGHTS NOTES:

- Fair lights are hung on lineset 6 with a trim height of 12'-0"
- Fair lights can be pulled from stock and Lighting Designer should be consulted on choice. These shown in drawing are based on production meeting mention of strings with 1'-0" centers for bulbs
- Penents should be placed between bulbs at center

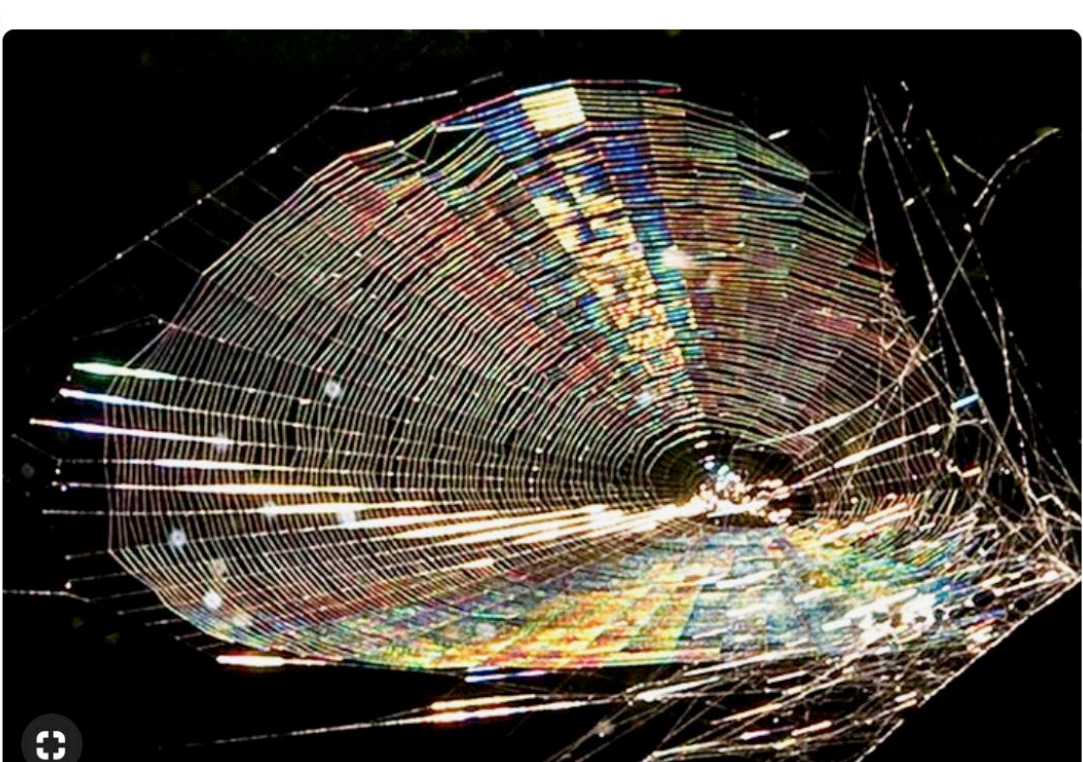
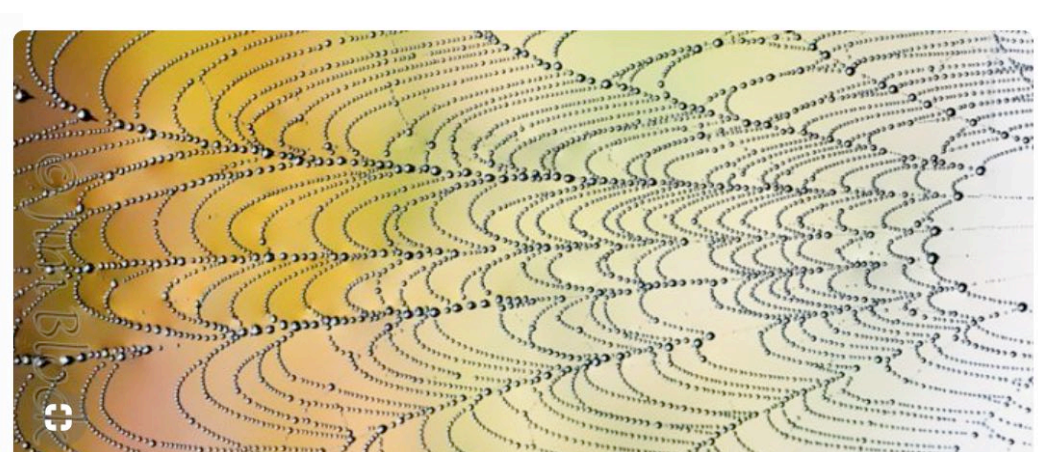

WEB NOTES:

- Side beams on web are similar to the rafters and are shown as 1/2" Plywood strips covering a 1" steel tubing frame. Actual construction up to TD discretion but should have a total front width of 6".
- Back side does not have to be covered.
- Beam seams should be spackled so rafters resemble 6" square lumber
- Web is shown with eyelet drilled into farthest poppits. Actual securing of points up to the discretion of TD
- Web can be constructed of any type of line or rope but must be climbable and able to hold weight.
- Web should be covered or constructed with a shiney, preferably metallic material so that it catches light.
- If possible, the joints of the web should have some sort of shiney fastener. This could be beads, nicropress sleeves or wire wrapping. Please discuss further with designer. Also see to reference images.
- The stage right beam and web section need to be able to swing fully flat against the Barn D unit back. This is only necessary for the first scene on Arable's farm. Once swung into it's onstage position, it can attach to the stage left beam (which is stationary and affixed to the ground). It will remain in this position for the rest of the show.

Charlotte's Web

ELV-Bk. Wall, Fair Lights, Web	Date : 11/23/2018
Arkansas Children's Theatre	Scale : 1/2" = 1'-0"
Director : Katie Campbell	10 OF 14
Designer : Vandy Scoates	
Revisions : 11/24/18	

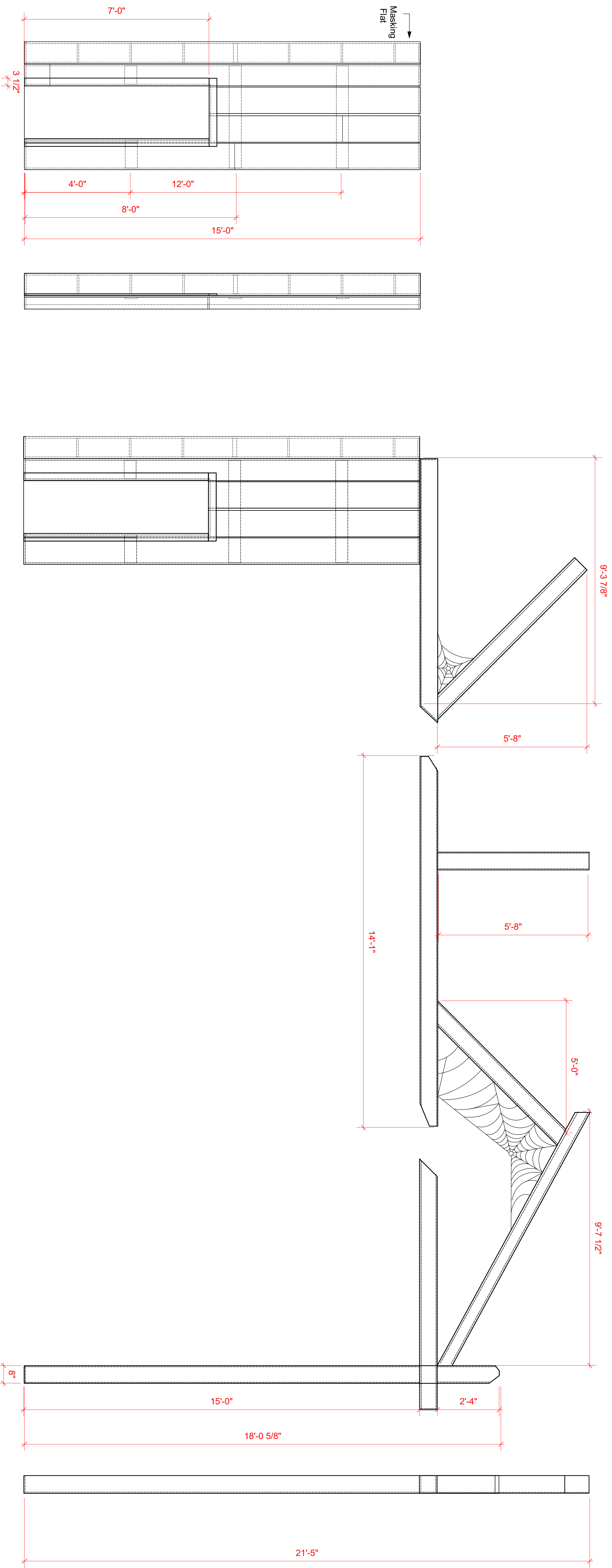

Barn D - Front View

Barn D - Side View

Barn D and Front Rafter- Front View

Front Rafter- Side View

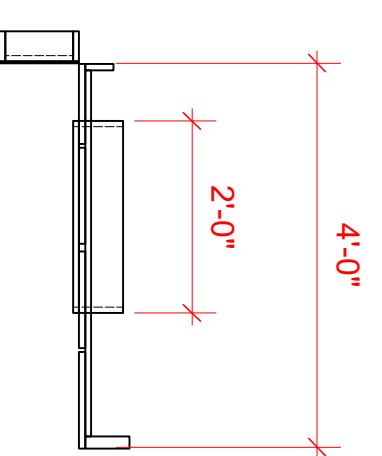

Barn D- Top View

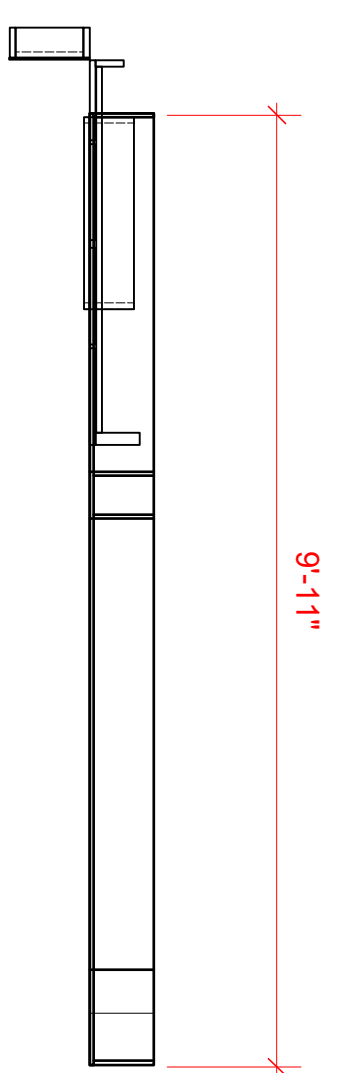

Barn D and Front Rafter- Top View

BARN D and FRONT RAFTERS NOTES:

- Barn planks are drawn as 3/4" Plywood strips. Strips are both 10" and 8" wide
- Actual materials for planks are at TD's discretion
- Slats have small gaps between them that vary in width. TD can choose actual width as long as total length equals 25'-0" and that they are placed at random.
- Planks vary in heights with seams sitting at 2'-0", 4'-0", 6'-0" and 8'-0". These seams should NOT be spackled or covered so seams shows through.
- Planks also have holes and distressed sections missing.
- Planks are shown as being backed with 1x6 but could be done with Plywood cut to 6" strips
- Rafter are shown as 1/2" Plywood strips covering a 1" steel tubing frame. Actual construction up to TD discretion but should have a total front width of 6". Back side does not have to be covered.
- Rafter seams should be spackled so rafters resemble 8" square lumber
- Various rafters have "spider webs" in them. These can be constructed with string or any material the TD and Scenic sees fit. They should be thick enough to be well seen from the audience.
- Masking flat shown as a standard hollywood style flat and is used for masking and stability only. Actual construction is up to the TD.
- Door opening is 2'-0" x 7'-0" and is surrounded by 1x3 trim. The door will have a fabric curtain over it. Fabric TDB and can be from stock.

Charlotte's Web

ELV-Front Barn Unit and Front Rafters Date : 11/23/2018

Arkansas Children's Theatre Scale : 1/2" = 1'-0"

Director : Katie Campbell

Designer : Vandy Scoates

Revisions : 11/24/18

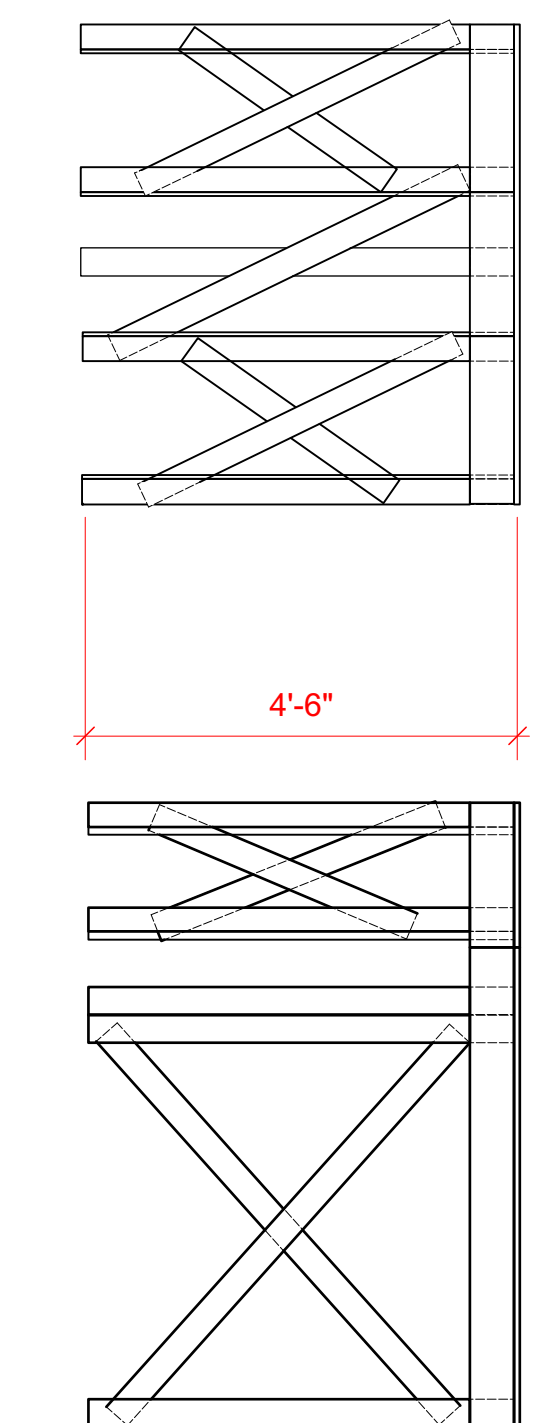

Platform A- Front View

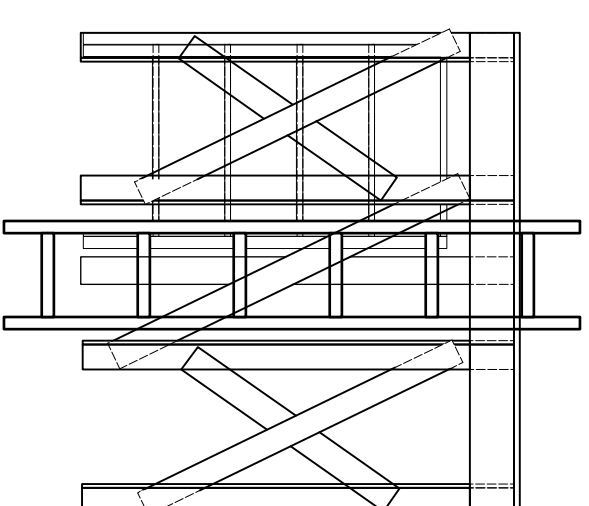

SR Unit- Front View

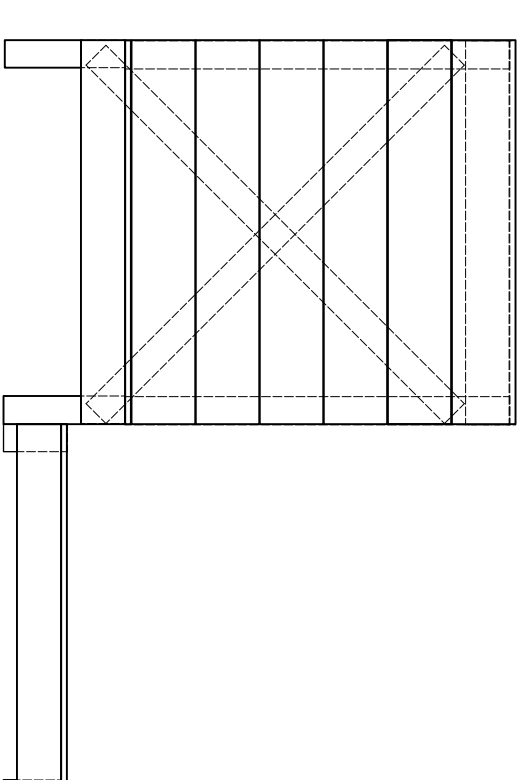

Platform B, C & D (SL Unit)
- Side view

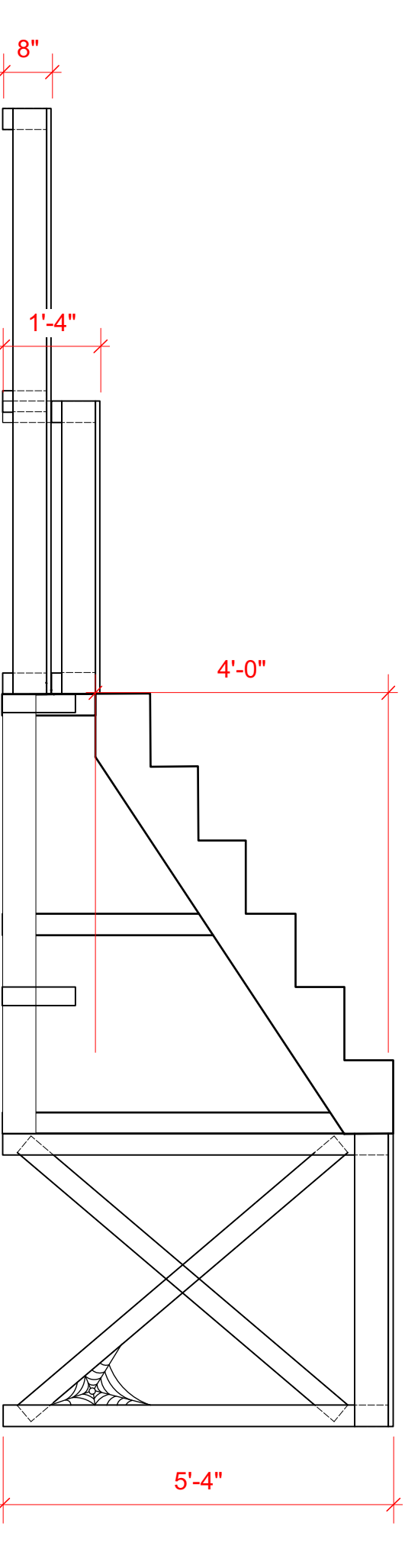

Platform B, C & D (SL Unit)
- Front View

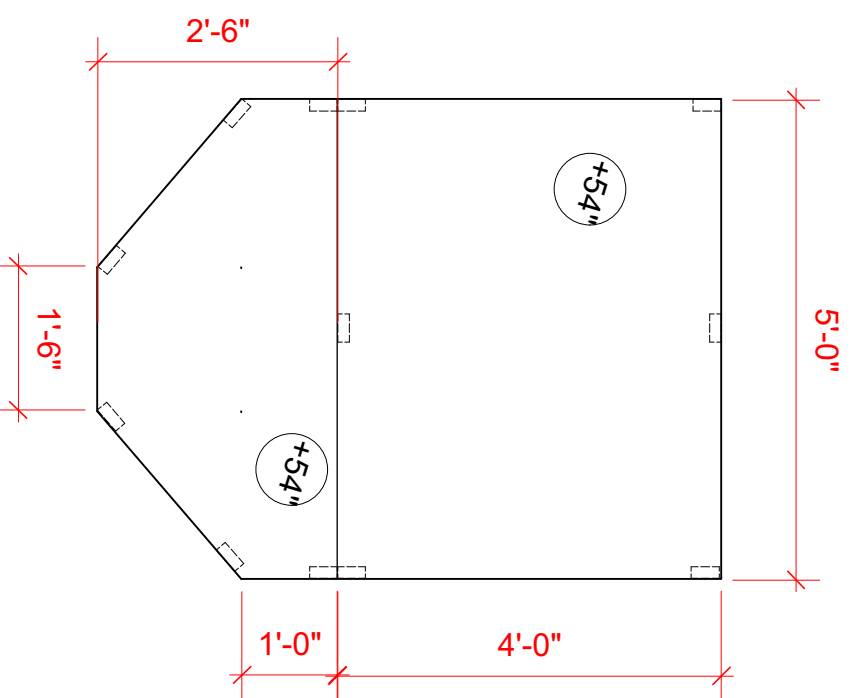

Platform A- Top View

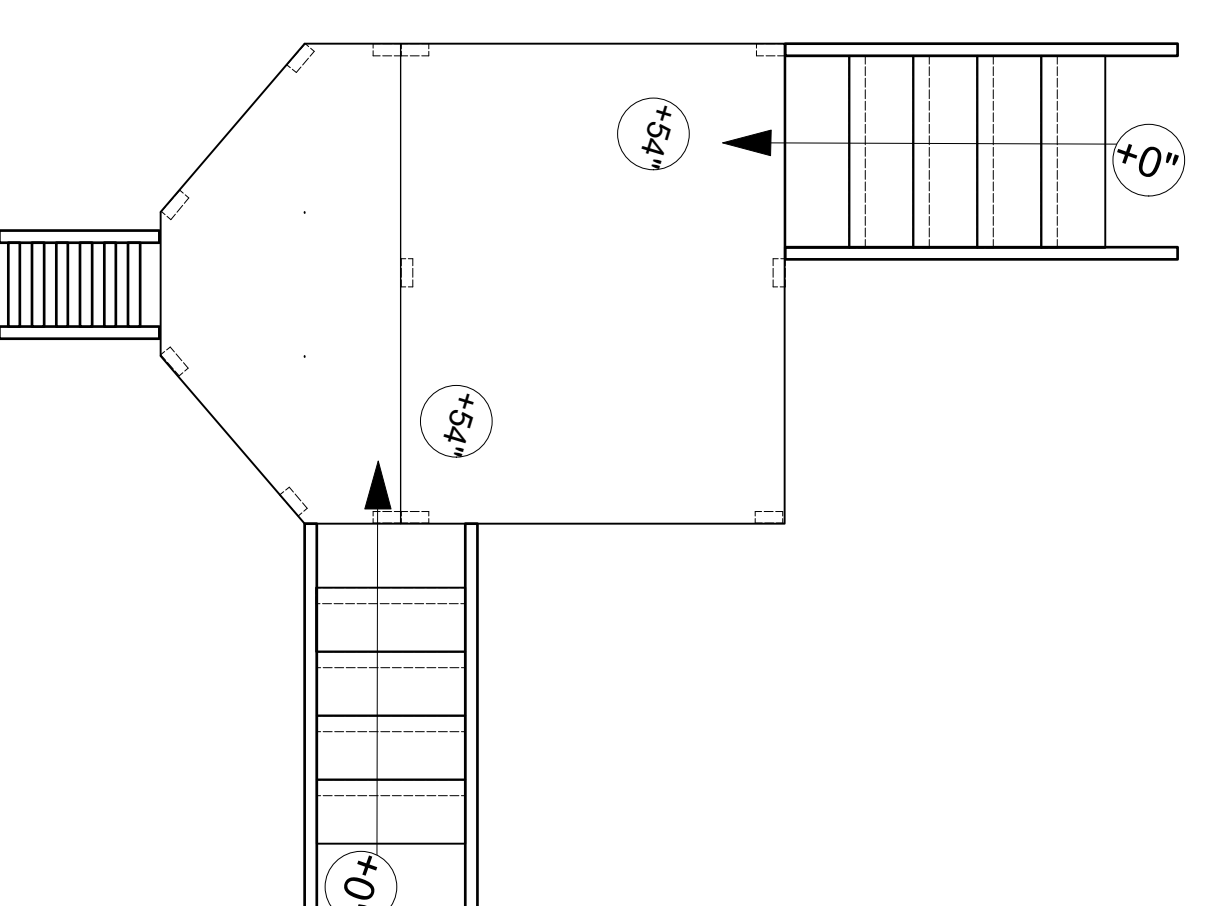

STUnit- Top View

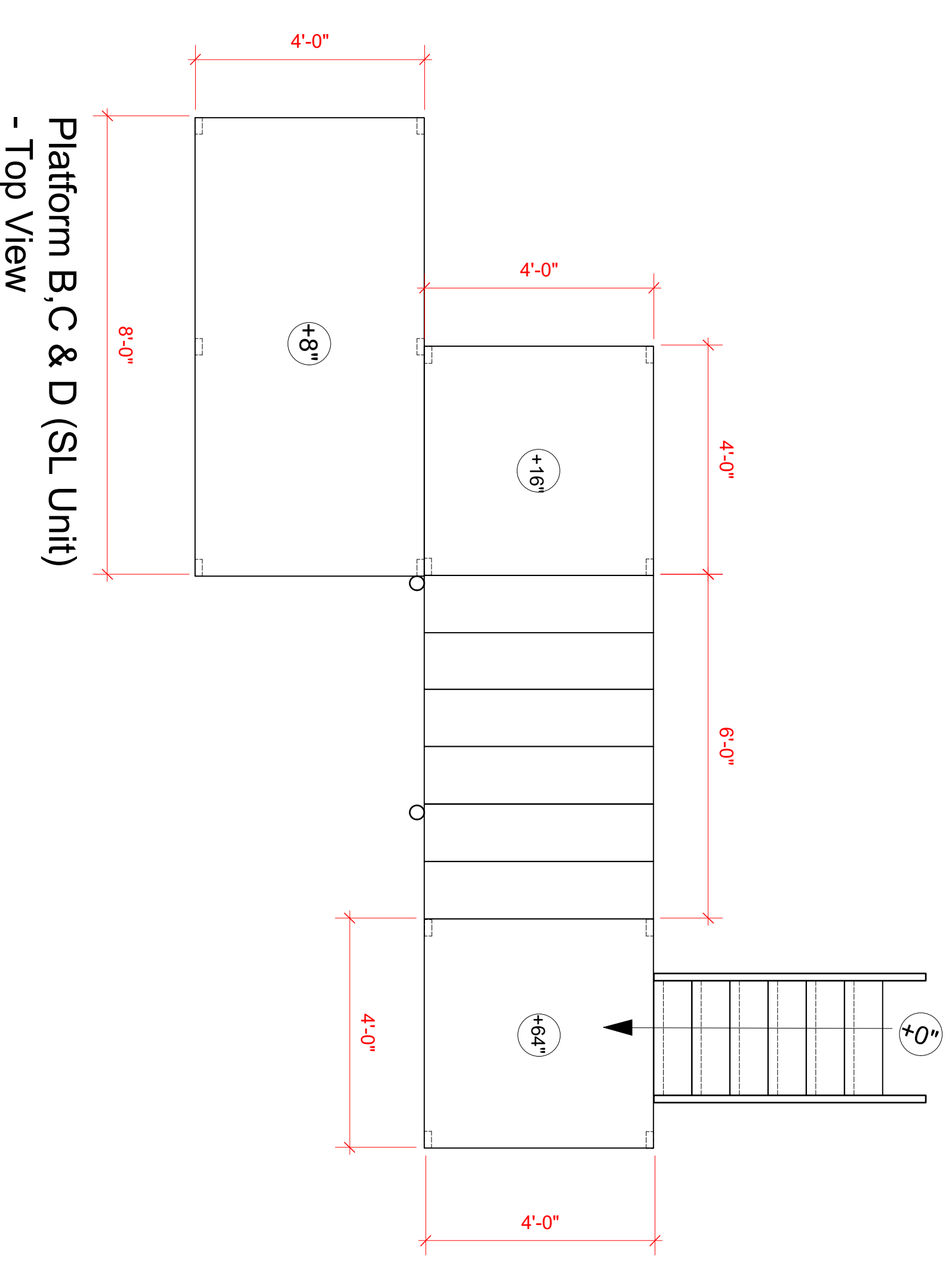

Platform B, C & D (SL Unit)
- Top View

PLATFORM A (SR UNIT) NOTES:

- Platform is a total height of 4'-6"
- Shown as a 4'-0" x 5'-0" platform and a trapezoidal platform but can constructed in any way the TD chooses
- Cross bracing is up to discretion of TD but should resemble an X whenever possible.
- See additional elevations for the ladder and ship ladder details.

PLATFORM B, C & D (SL UNIT) NOTES:

- Platform is a total heights of 8" (B), 1'-4" (C) and 5'-4" (D)
- Shown as standard/stock 4'-0" x 8'-0" (B) and 4'-0" x 4'-0" (C&D) platforms
- Cross bracing is up to discretion of TD but should resemble an X whenever possible.
- See additional elevations for ship ladder details.
- Main stair unit can be stock 4'-0" tall stairs. Preferably the stair length will not exceed 6'-0" but can be discussed with designer.
- Bottom of main stair unit will have two peices of pipe, 1'-0" tall that will hold the Fair Sign unit (see separate elevation). The pipes should be attached to unit and to floor.
- Platform D has a "spider web" in it. This can be constructed with string or any material the TD and Scenic sees fit. It should be thick enough to be well seen from the audience.

Charlotte's Web

ELV- SL and SR Platform Units

Arkansas Children's Theatre

Director : Katie Campbell

Designer : Vandy Scoates

Revisions : 11/24/18

Date : 11/23/2018
Scale : 1/2" = 1'-0"

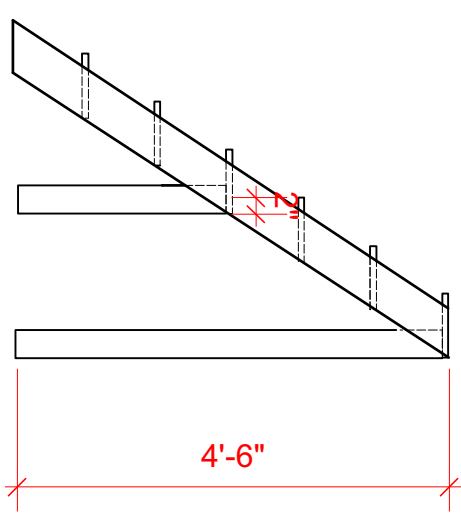

SL Unit Back Ladder-
Side View

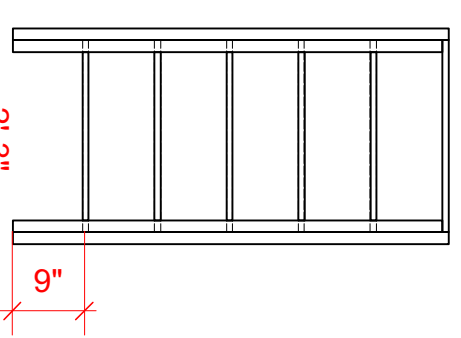

SL Unit Back Ladder-
Front- View

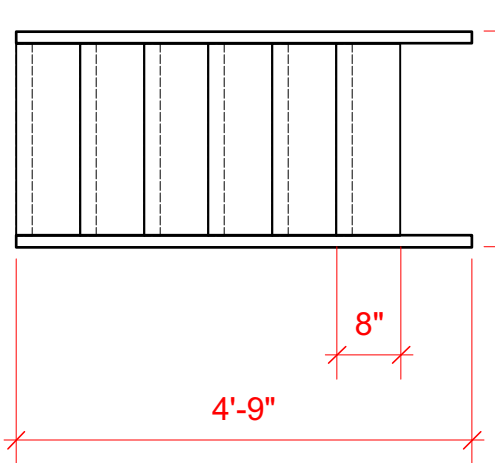

SL Unit Back Ladder-
Top View

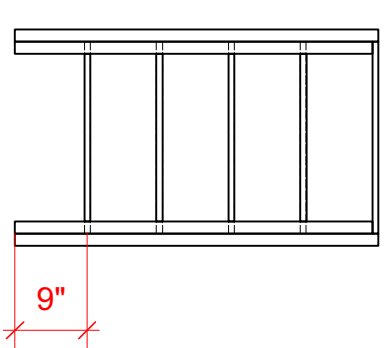

SR Unit Back Ladder-
Front- View

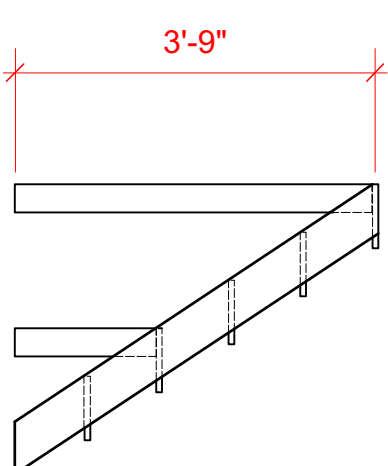

SR Unit Back Ladder-
Side View

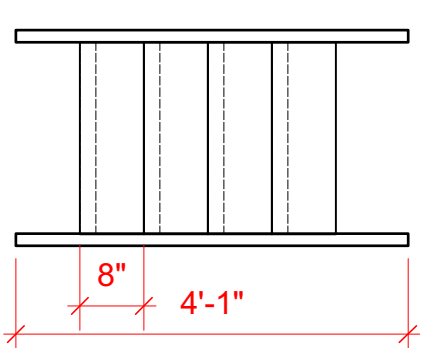

SR Unit Back Ladder-
Top View

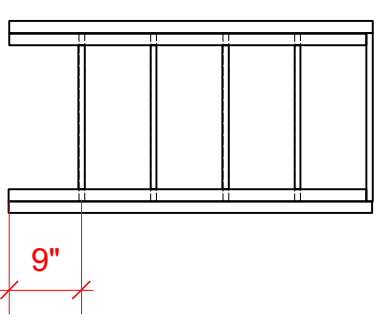

SR Unit SL Ladder-
Front- View

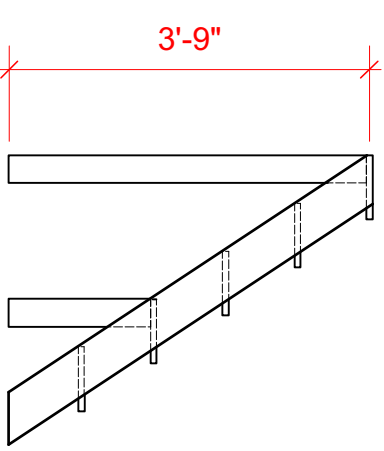

SR Unit SL Ladder-
Side View

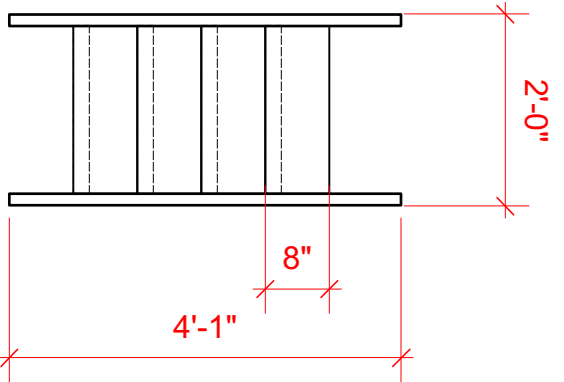

SR Unit SL Ladder-
Top View

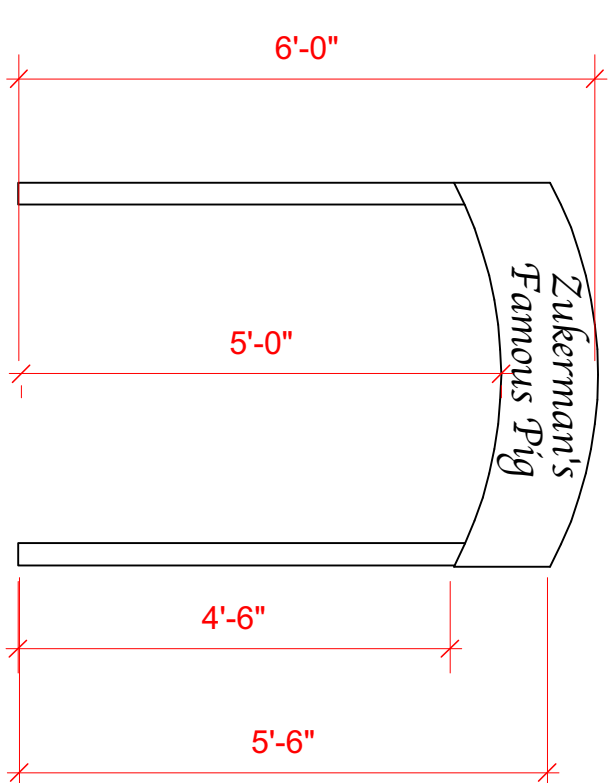

Fair Sign - Front View

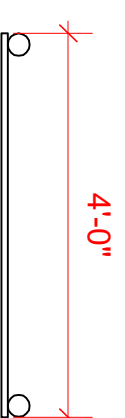

Fair Sign - Top View

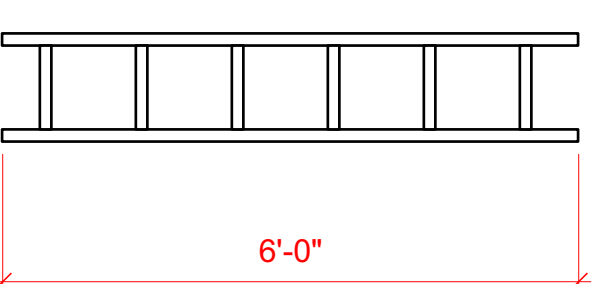

Ladder- Front View

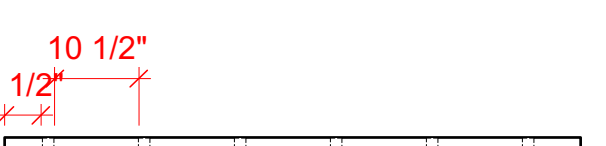

Ladder- Side View



- SR and SL UNIT LADDERS NOTES:**
- All ladder units are constructed like ship ladders. If there are step units or ladder in stock that are these sizes and heights, those can be used.
 - All ladder units can be cross braced in what ever way TD sees fit.
 - All units are 9" rise and 8" run with a 2" overlap for each step.
 - Note all ladders are slightly different sizes.

- FAIR SIGN NOTES:**
- Fair sign is on dowels or pipes that are slightly smaller than pipes attached to the SL platform Unit (see sperate elevation) so that the uprights may fit in tightly.
 - See paint elevation for actual lettering
 - Unit may need a second way to attach to SL unit stairs for stability.

- LADDER NOTES:**
- Ladder can be purchased or constructed.
 - Ladder total height should be 6'-0" tall and no more than 1'-6" wide.
 - See reference image for paint texture and construction

Charlotte's Web

ELV-Stair Units, Fair Sign, Ladder

Arkansas Children's Theatre

Director : Katie Campbell

Designer : Vandy Scoates

Revisions : 11/24/18

Date : 11/23/2018
Scale : 1/2"=1'-0"

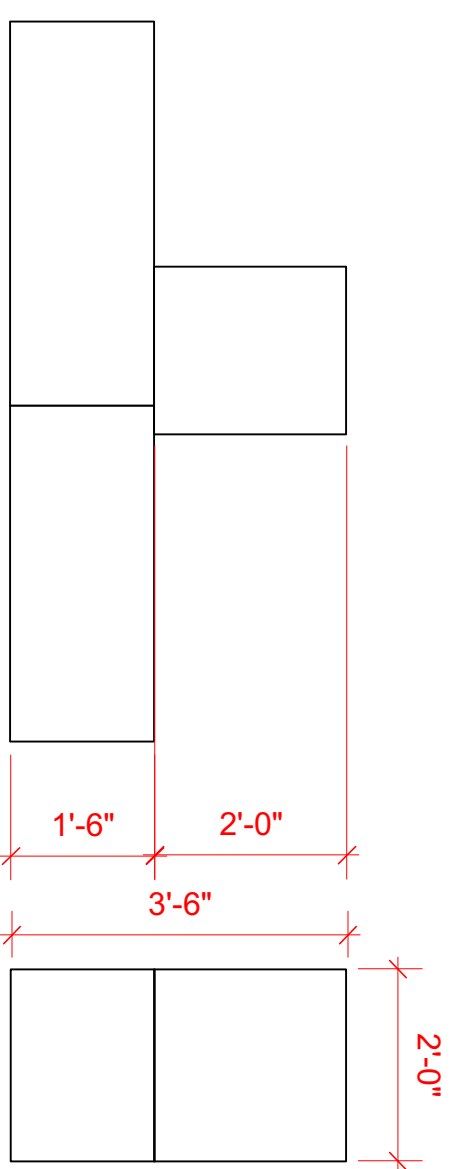

Hay A- Front View

Hay A- SideView

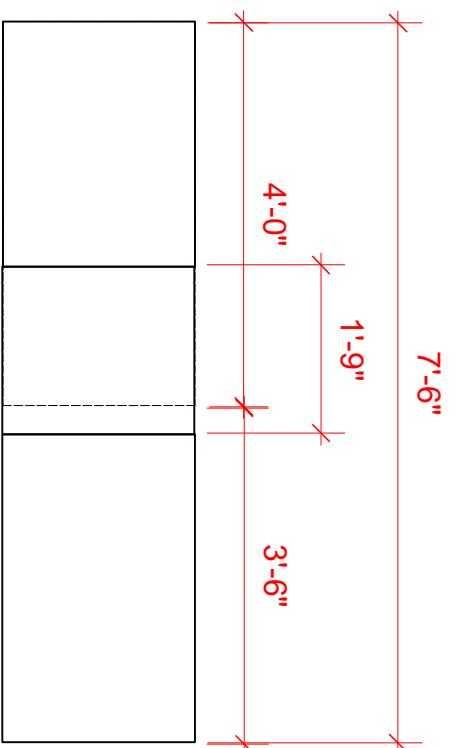

Hay A- Top View

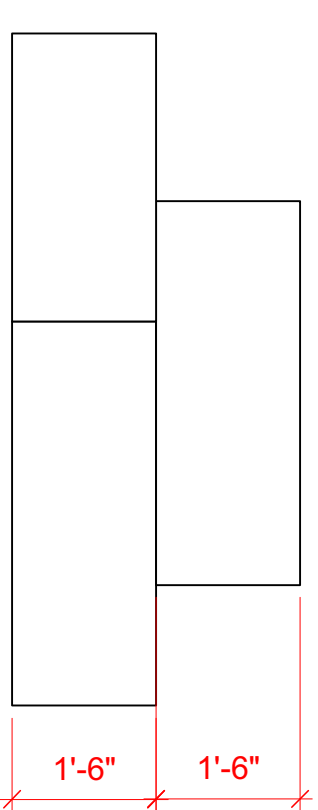

Hay D- Front View

Hay D- SideView

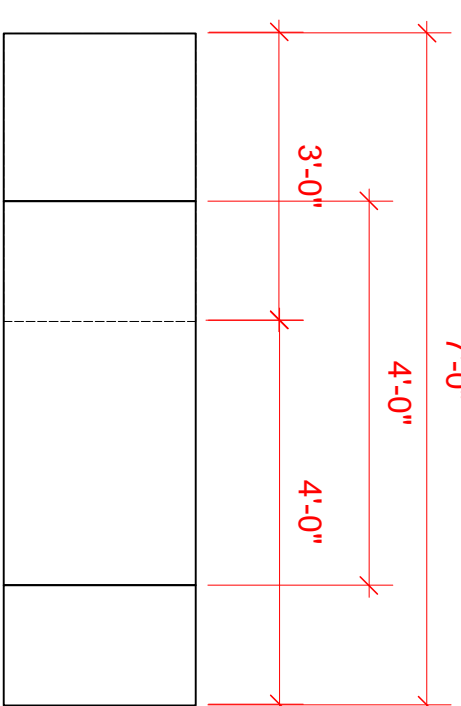

Hay D- Top View

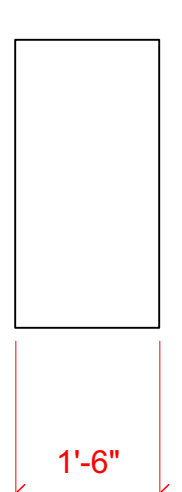
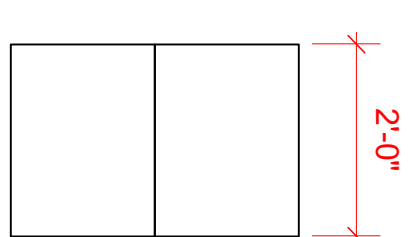

Hay G (movable)- Front View

Hay G (movable)-Side V

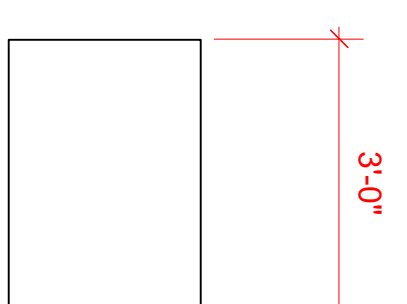

Hay G (movable)- Top View

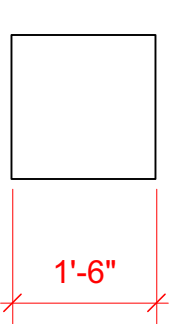
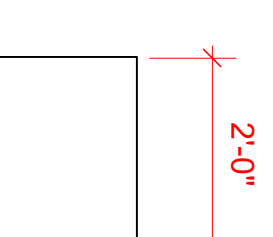

Hay B- Front View

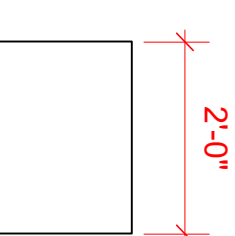

Hay B- SideView

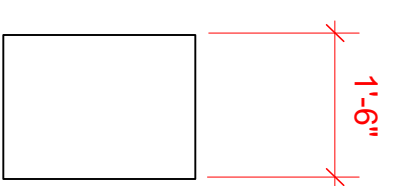

Hay B- Top View

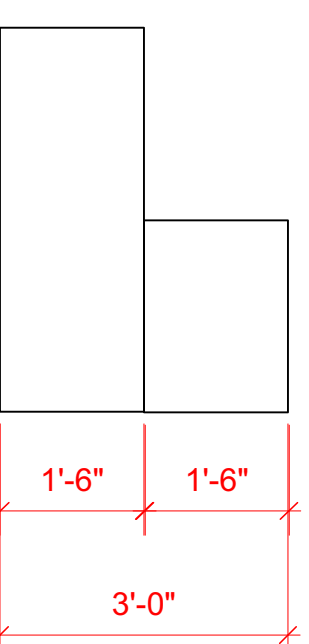

Hay E- Front View

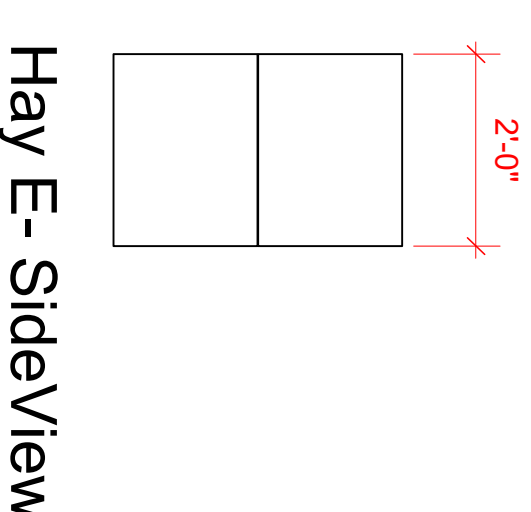

Hay E- SideView

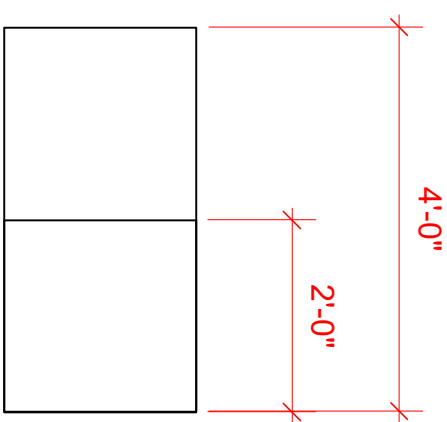

Hay E- Top View

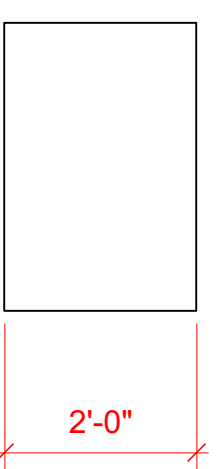

Hay C- Front View

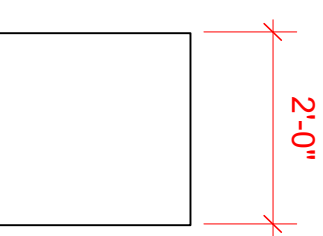

Hay C- SideView

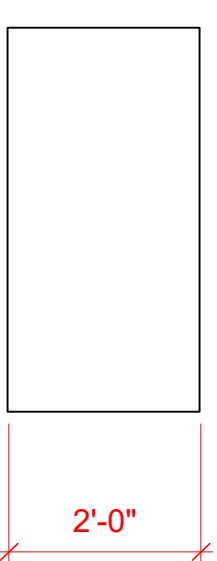

Hay F (movable)- Front View

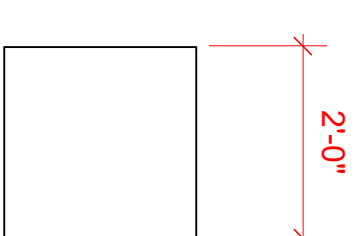

Hay F (movable)-Side View

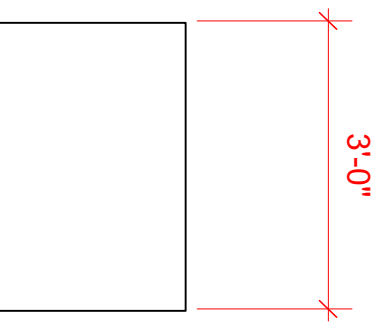

Hay C Top View

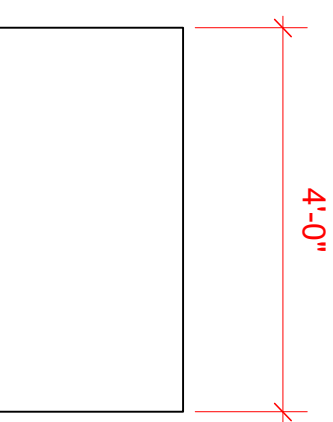

Hay F (movable)- Top View

NOTES:

- All Hay stacks can be made to TD discretion
- Hay Stacks A through E are stationary and need to be sitable and standable
- Hay Stacks F and G are movable and also need to be standable and sitable.
- Hay Stacks F and G can be made of Foam as discussed in production meeting
- Designer would prefer that hay or haylike material be attached to each stack for texture but could be textured and painted by Scenic. This can be left to TD discretion.
- If theater has Apple crates or small barrels that are similar in size to any parts of hay stacks A through E, they may be substituted.
- If haystacks are made of wood, all edges should be given 1/2" roundover for a smooth edge.

Charlotte's Web

ELV-Hay Date : 11/23/2018

Arkansas Children's Theatre Scale : 1/2"=1'-0"

Director : Katie Campbell

Designer : Vandy Scoates

Revisions : 11/24/18